

INSTALLATION INSTRUCTIONS

DESCRIPTION: Top Case Mount
PART NUMBER: 2BS-F84X0-V0
MODEL: 2012+ Super Ténéré 1200



⚠ WARNING

Please read and understand these instructions completely before installation to avoid possible injury, or damage to the accessory or vehicle.

WARRANTY INFORMATION:

In the United States, see your Yamaha dealer for a copy of the Yamaha Genuine Parts and Accessories Limited Warranty.

NOTICE:

Installation of this kit requires a torque wrench and should be performed by an authorized Yamaha dealer or a qualified mechanic.

DEALER OR INSTALLER:

These instructions contain important information for future reference and *must* be given to the customer.

PARTS LIST:

No.	Part Number	Description	Qty
--	2BS-F84X0-V0	Top Case Mount	--
①	-	Trunk Mount Plate	1
②	-	M8x50 Socket Head Counter Sink Screw	1
③	-	M8x120 Socket Head Counter Sink Screw	2
④	-	M8x120 Button Head Bolt	2
⑤	-	∅16x25mm Spacer	1
⑥	-	∅22x30mm Spacer	2
⑦	-	∅18x69mm Spacer	2
⑧	-	M8 Washer	2
⑨	-	Flat Washer	1

* Part supplied with kit only and not available separately.

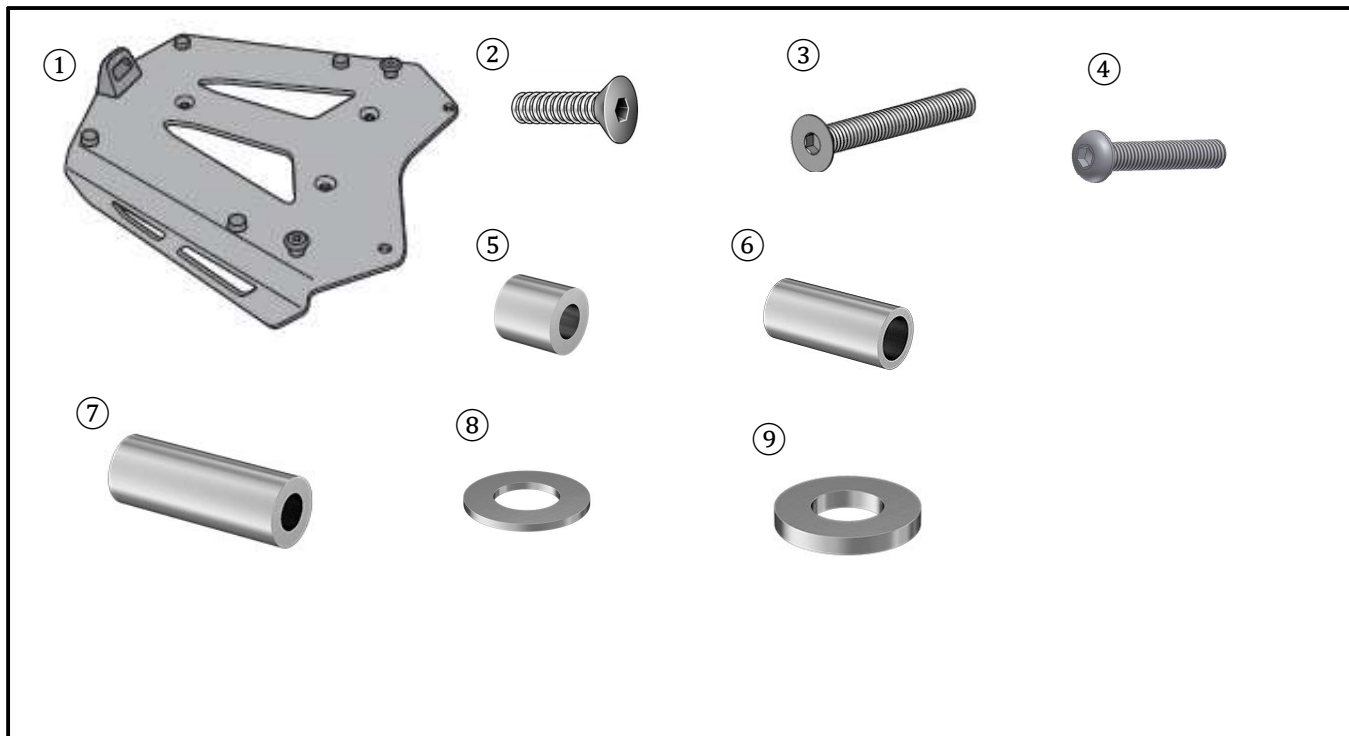

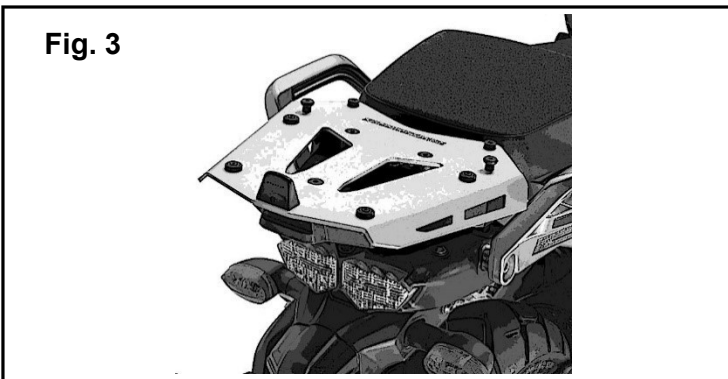
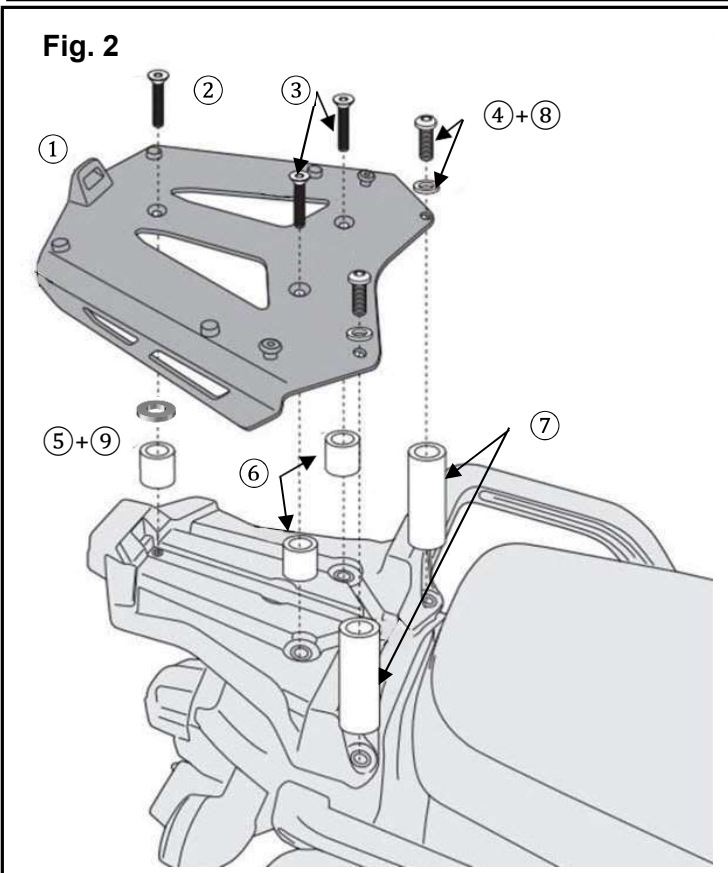
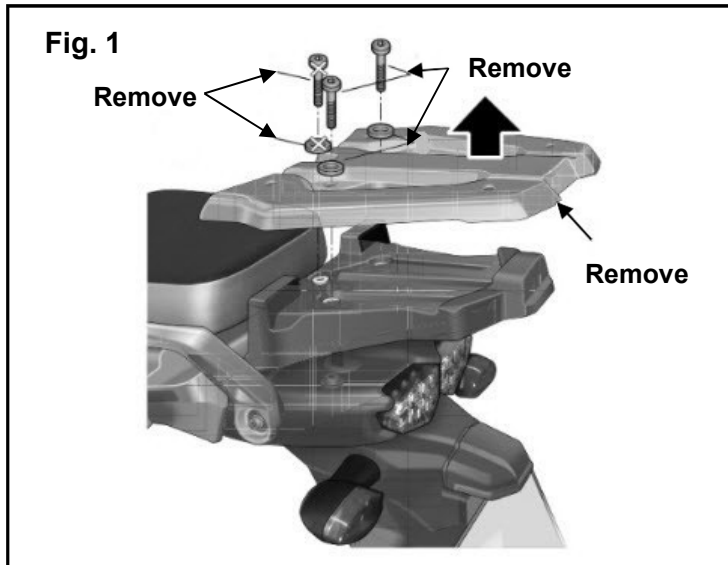

PREPARATION:

- Place the vehicle on a secure and level surface.
- Clean the mounting surfaces before beginning installation.

INSTALLATION:

1. Remove the stock rear rack. The hardware will not be reused. (Fig. 1)
2. Place the (7) ø18x69mm Spacers on the mounting holes close to the seat. (Fig. 2)
3. Place the (6) ø22x30mm Spacers in the middle mounting holes. (Fig. 2)
4. Place the (5) ø16x25mm Spacer in the last mounting hole at the rear of the frame. (Fig. 2)
5. The (9) Flat Washer goes between the (5) ø16x25mm Spacer and the (1) Trunk Mount Plate. (Fig. 2)
6. Place the (1) Trunk Mount Plate over the spacers and align the mounting holes. (Fig. 2)
7. Place the two (8) M8 Washers over the two (4) M8x120 Button Head Bolts. Insert the (4) M8x120 Button Head Bolts into the front mounting holes closest to the seat.
8. Thread the two (3) M8x120 Socket Head Counter Sink Screws into the middle mounting holes.
9. Thread the (2) M8x50 Socket Head Counter Sink Screw into the rear mounting hole.
10. Torque all hardware to 20Nm (2.0 kg-m or 14 lb-ft)

Max load: 22lbs (10kg) and top speed of 74mph with the Top Case attached. The Top Case Mount alone has a weight limit of 13 lbs. (5.8 Kg)

MAINTENANCE:

Periodically, check torque on all hardware. If loose hardware is found, re-torque to specification.

CARE AND CLEANING:

Clean painted metal parts with a clean soft cloth and mild soap and water solution. Rinse and dry.

CUSTOMER SERVICE:

For further information see your Yamaha dealer.

ESTIMATED TIME TO INSTALL: 0.5 HRS.

2BS-F84X1-V0_1 TOP CASE MOUNT KIT